

Quick Start Guide

FaceDepot-7B

Version: 1.0

Date: October 2018

Overview

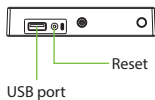
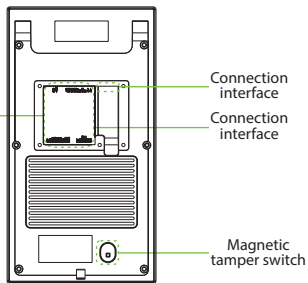
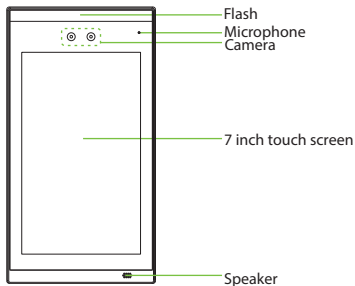

Connection interface

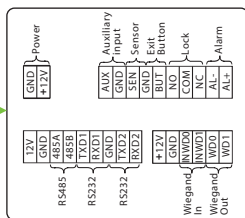

FP & RFID Reader (Optional)

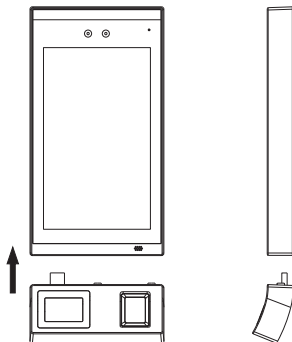
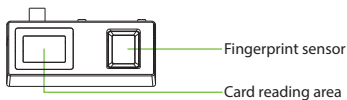

Device Installation

Method 1: Installation on the wall

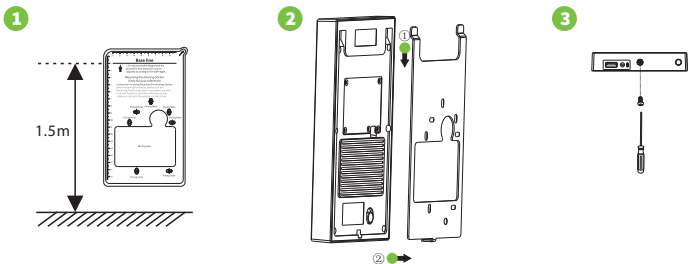

- ① Attach the mounting template sticker to the wall, and drill holes according to the mounting paper. Fix the back plate on the wall using wall mounting screws.
- ② Attach the device to the back plate.
- ③ Fasten the device to the back plate with a security screw.

Note: If you want to install FP & RFID reader, please insert the reader after step ①.

Method 2: Install on the barrier gate

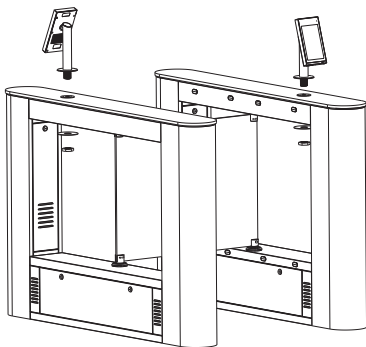

Adjust the device

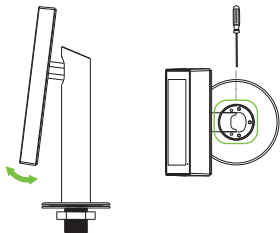

1. Adjust the angle of the device.
2. Fix the screws.

Please route the wire through the bracket before installation.

1. Drill a hole on the barrier gate.
2. Insert the bracket into the hole and fix it with a nut.
3. Adjust the angle of the device.

Standalone Installation

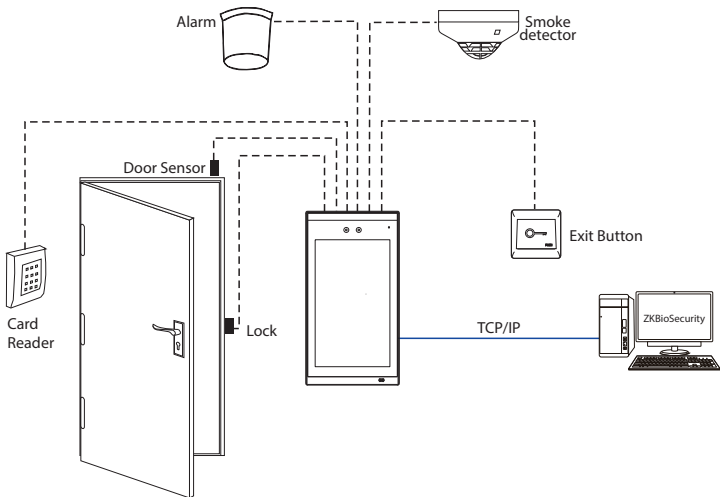

Note: On this document, we just guide you to connect some normal components, if you want more connection of SRB, external fingerprint reader and so on, please check user manual document.

Door Sensor, Exit Button & Alarm Connection

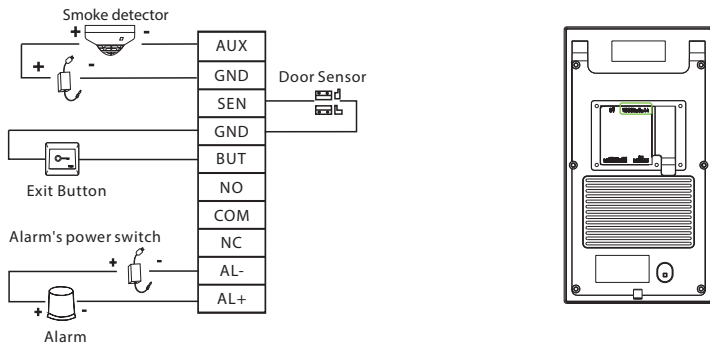

Lock Relay Connection

The system supports Normally Opened Lock and Normally Closed Lock.

The NO LOCK (normally opened at power on) is connected with 'NO' and 'COM' terminals, and the NC LOCK (normally closed at power on) is connected with 'NC' and 'COM' terminals. Take NC Lock as an example below:

1) Device not sharing power with the lock

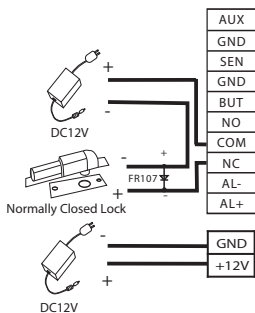

2) Device sharing power with the lock

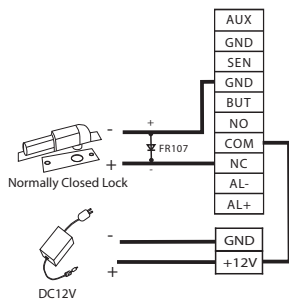

Wiegand Input Connection

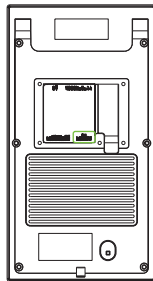
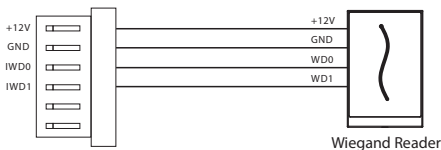

Barrier Connection

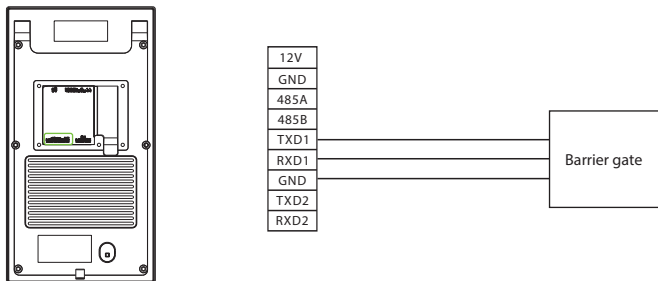

Ethernet Connection

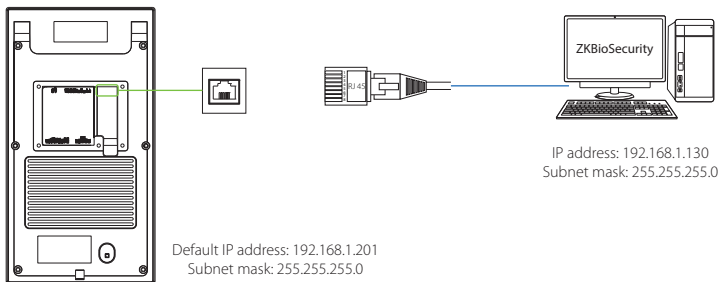

Click [Settings] > [Network Settings] > [TCP/IP Settings] > [DHCP], input the IP address and click [OK].

Note: In LAN, IP addresses of the server (PC) and the device must be in the same network segment when connecting to ZKBioSecurity software.

Power Connection

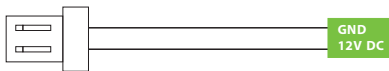
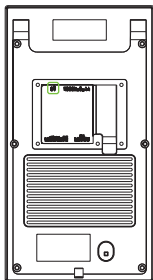

Recommended power supply



- 1) 12V \pm 10%, at least 3000mA.
- 2) To share the power with other devices, use a power supply with higher current ratings.

Quick Start



◆ User registration

Register on the device

Click  > Employee >  to register new employee. Enter employee name, ID, register face, fingerprint, badge number (fingerprint and ID card are optional), and password.

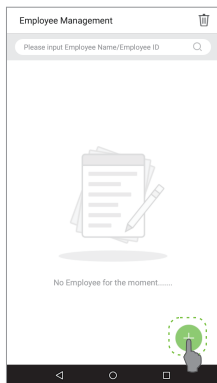
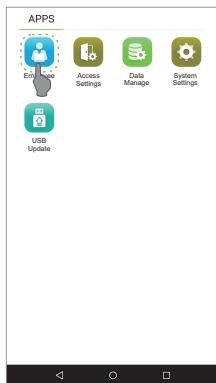
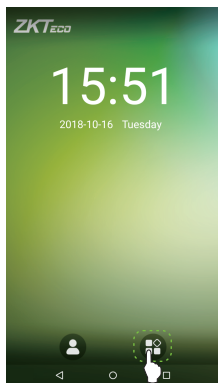

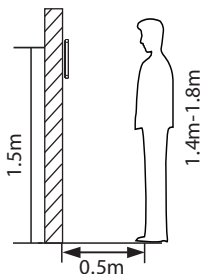

Note:

1. It's recommended to register multiple administrators.
2. It's recommended to enroll a user's face at a 0.5m distance, which is good for a 1.4~1.8m height person.

Register on the software

We recommend using ZKBioSecurity 3.1.5.0 or above.

Please set the IP address and cloud service server address on the device.

1. Click [Access] > [Access Device] > [Device] > [Search Device] to add the device to the software.

When the device has set the server address and port, it can be added automatically.

The screenshot shows the software interface for searching and adding devices. The 'Search Device' window is active, showing a search progress bar at 100%. A table of found devices is displayed, with the 'Add' button highlighted for the first device. An 'Add' dialog box is open, showing the following fields and values:

IP Address	MAC Address	Subnet Mask	Gateway Address	Serial Number	Device Model	Server Address	Operation
192.168.214.9		255.255.255.0	192.168.214.254	AJPS15180088	MS0080 Pro		Add
192.168.12.252		255.255.255.0	192.168.12.254	AJPS15180088	MS0080 Pro		This device has been added



The 'Add' dialog box contains the following fields:

- Device Name*: 192.168.214.9
- Communication Password: [Empty]
- Area*: Area Name
- Add to Level: [Dropdown menu]
- Clear Data in the Device when Adding:

A warning message is displayed: [Clear Data in the Device when Adding] will delete data in the device (except event record), please use with caution!

The dialog box has 'OK' and 'Cancel' buttons at the bottom.

2. Click [Personnel] > [Person] > [New] to register users in the software.
 3. Add users to access levels.
 4. Click [Access] > [Device] > [Device Control] > [Synchronize All Data to Devices].
- For more details, please refer to the ZKBiosecurity User Manual.

Note: The icons  or  in the standby interface indicates that the network connection or the server is abnormal. Please check the network cable and network connection.

Register on the phone

Once ZKBioSecurity software installation, users could enroll face via browser application on their own mobile phone.

Cloud server IP address Server port

Login onto <http://X.X.X.X.XX/app/v1/adreg> with mobile phone browser application to register users.

The users will display in [Personnel] > [Temporary Personnel], click [Review].

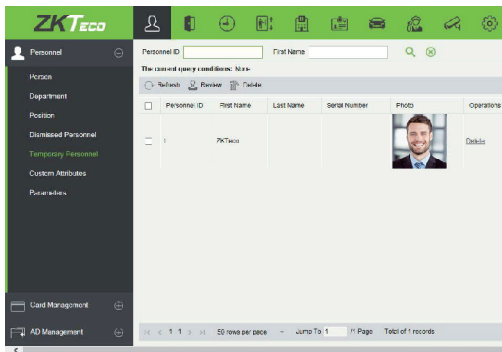
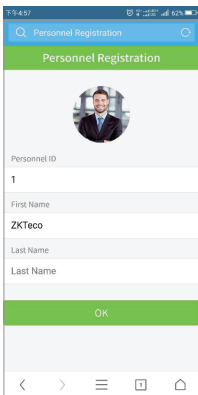

❖ User Authentication

Terminal could detect face in 0.3m to maximum 3m distance. The device switches to face verification interface automatically once it detect bright of environment change. The verification result shows as right image.

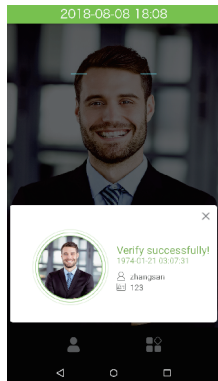

Verification is successful

❖ View records

View records on the software

Click [Access] > [Report] on the software to view the records.

ZK Building, Wuhe Road, Gangtou,
Bantian, Buji Town, Longgang
District, Shenzhen China 518129
Tel: +86 755-89602345
Fax: +86 755-89602394
www.zkteco.com

