

ZK Building, Wuhe Road, Gangtou, Bantian, Buji Town,
Longgang District, Shenzhen China 518129

Tel: +86 755-89602345

Fax: +86 755-89602394

www.zkteco.com



Copyright©2019 ZKTECO CO., LTD. All rights reserved.

5 Delete Fingerprints

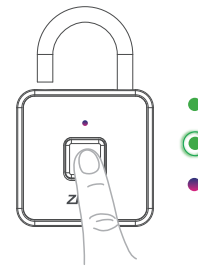

After unlocking the lock, verify with **administrator fingerprint** and keep pressing on the sensor until the blinking green LED turns to bluish red.

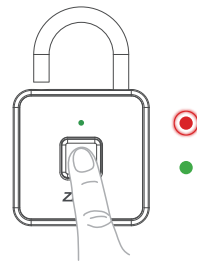

Now move the finger from the sensor, and then press again with **administrator fingerprint** on the sensor until the blinking red LED turns to green, which indicates **all the fingerprints are deleted**.

Note: Do not move the finger from the sensor until the red LED blinks, otherwise the deletion will interrupt.

6 Low Power Alert and Recharge

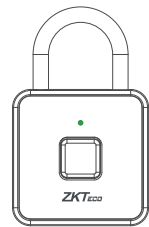

For charging remove the silicone USB plug, then insert the USB cable and link it to any PC/tablet or charge pal. The red LED will be blinking while charging. After about 60 minutes of charging, the green LED will light up, which indicates the completion of charging.

If the system detects low power, the yellow LED will blink when you touch the sensor. You can still open the lock for about 50 times when the yellow LED blinks.

If the battery is totally discharged, you need to link the lock to a charge pal or other portable power supply before trying to unlock it. After unlocking, recharge the lock.

User Manual

Padlock

Version: 1.1

Date: Jul 2019

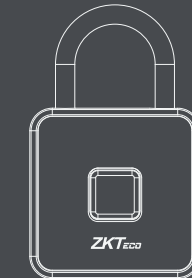

1 Factory Default Mode

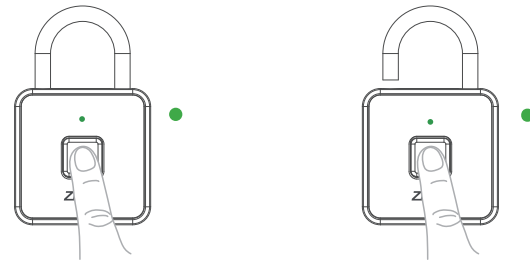

Factory settings of all new locks allow **any fingerprint** to unlock them.

2 Register First Fingerprint



Unlock the lock with **any fingerprint** and keep pressing on the sensor until the green LED blinks.

Now move the finger from the sensor and the blue LED will blink, which means the lock has entered in registration mode.

Then press a desired finger on the sensor, and move the finger when the green LED lights up, then press the same finger two more times until the lock turns off automatically, which means the fingerprint is registered.

Note: The maximum number of fingerprints the lock can register is 10, where the first two registered fingerprints belong to the administrator group, and they have the right to register or delete other fingerprints.

3 Verify and Unlock

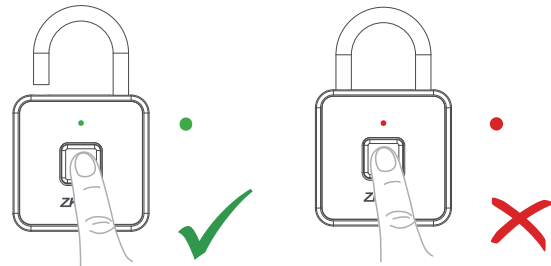

Press a registered finger on the sensor, the green LED lights up if the verification is successful, and then the lock will unlock automatically. If the red LED lights up, then please press your finger correctly.

Note: After seven failed verifications, the lock will turn off automatically.

4 Register More Fingerprints

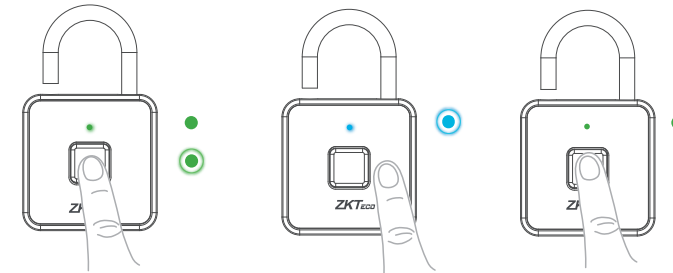

After unlocking the lock, verify with **administrator fingerprint** and keep pressing on the sensor until the green LED blinks.

Now move the finger from the sensor and the blue LED will blink, which means the lock has entered in registration mode.

Then press a new finger on the sensor, and move the finger when the green LED lights up, then press the same finger two more times until the lock turns off automatically, which means the fingerprint is registered.